

FILED - 11/20/19

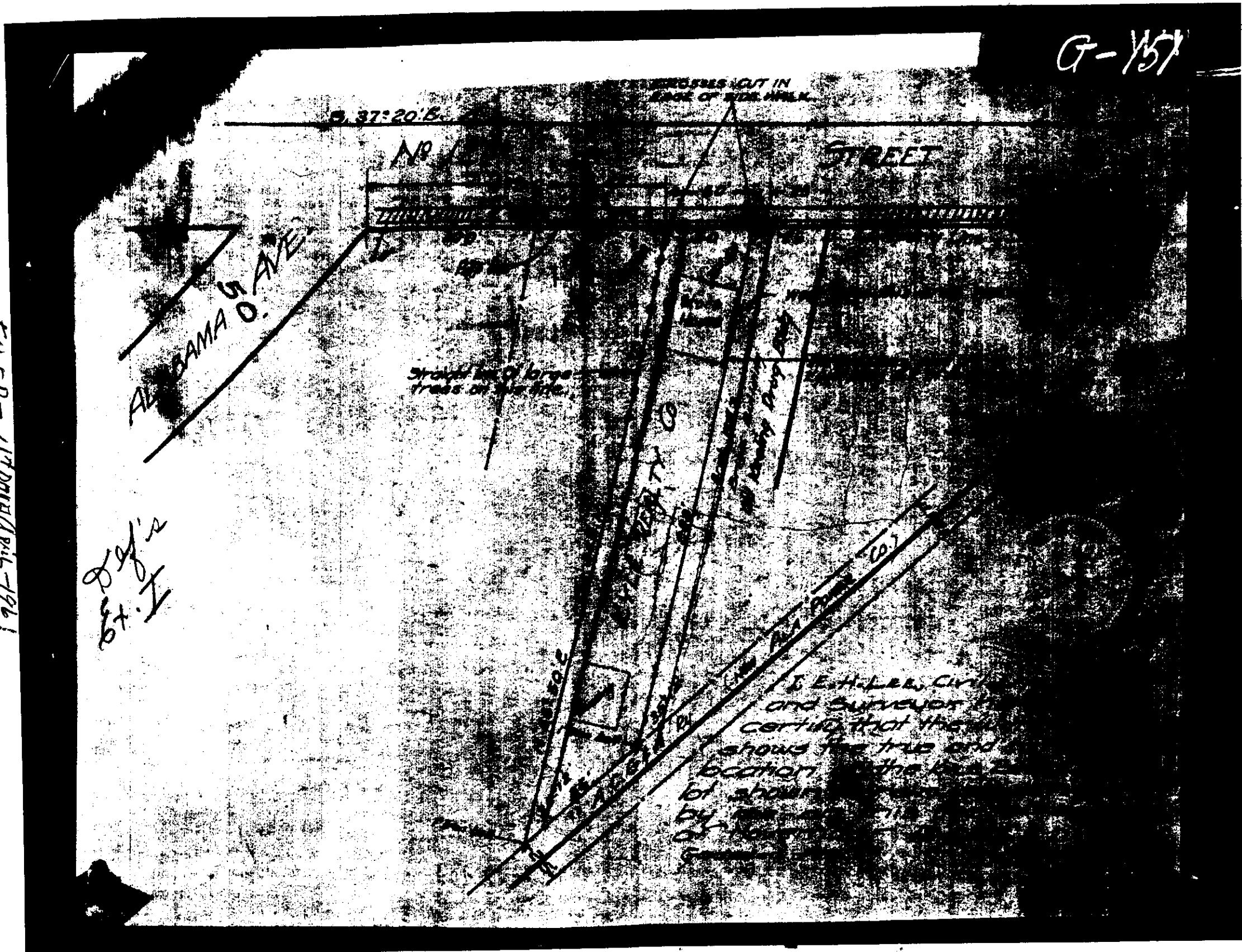

STATE OF ALABAMA  
 ETOWAH COUNTY OFFICE OF PROBATE JUDGE  
 I hereby certify that this instrument was filed in office for record on  
 the 11 day of April 1964 at \_\_\_\_\_ o'clock  
 was duly recorded on the \_\_\_\_\_ day of \_\_\_\_\_ 1964  
 The following fees have been paid:  
 Cert. Fee \_\_\_\_\_  
 Reg. Tax \_\_\_\_\_  
 Deed Tax \_\_\_\_\_  
 Rec. Fee \_\_\_\_\_  
 DMI \_\_\_\_\_  
 \_\_\_\_\_ Judge of Probate Etowah County, Ala.

G-157