

NW CORNER NE 1/4 NE 1  
SEC 26 T. 11 S. R. 6 E

*Approved by [Signature]*

626-1

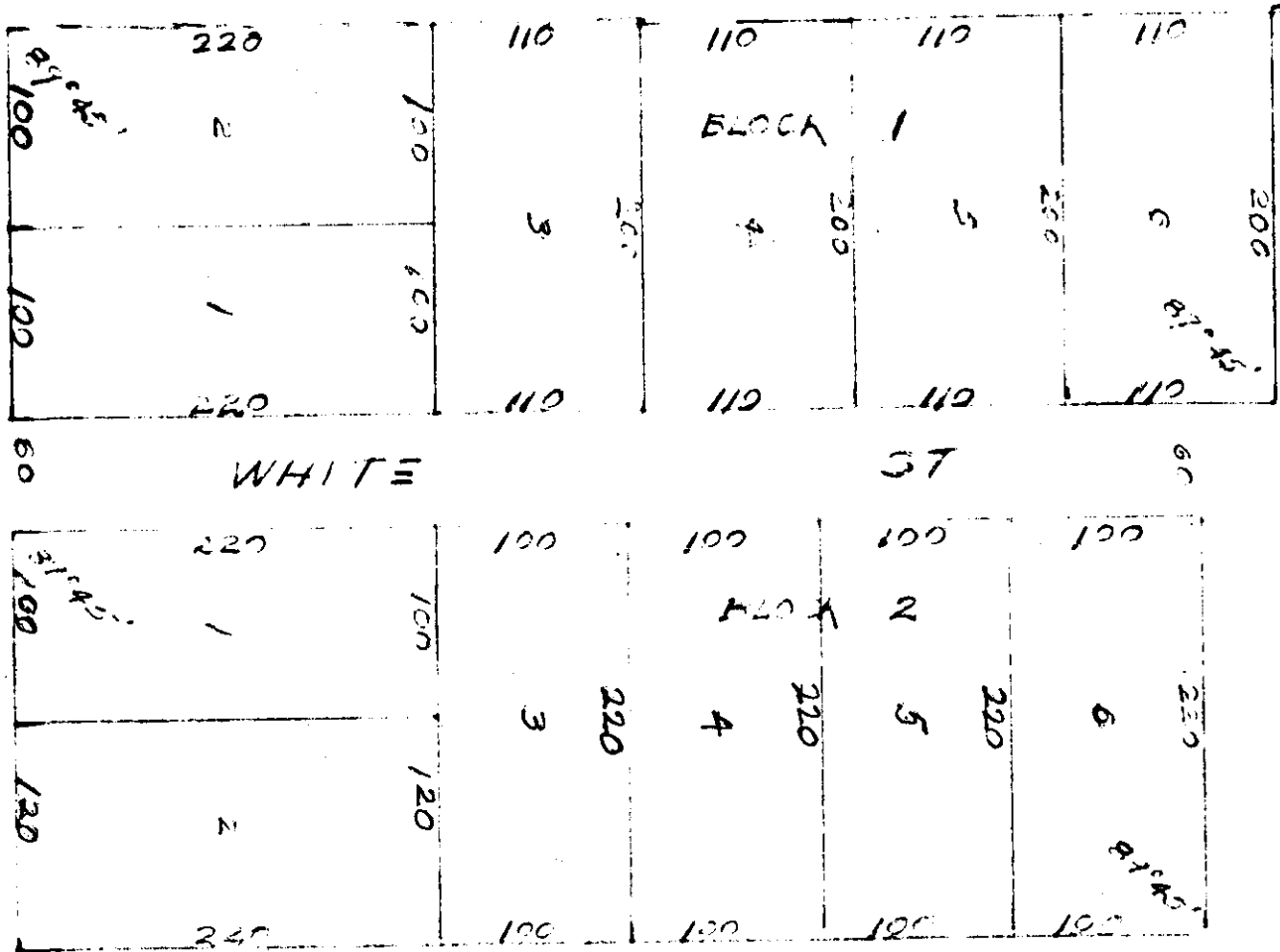
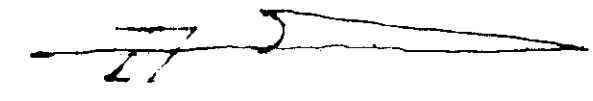

WHITE'S SUBDIVISION

STATE OF ALABAMA  
 COUNTY OF ETOWAH  
 I, THE UNDERSIGNED, A REGISTERED ENGINEER-SURVEYOR  
 OF SAID COUNTY, ALABAMA, BEING DULY SWORN, DO HEREBY  
 CERTIFY THAT THE FOREGOING IS A TRUE AND CORRECT  
 COPY OF THE ORIGINAL RECORD OF THE SAID SURVEY  
 AS THE SAME APPEARS IN MY OFFICE RECORDS.  
 W. F. WHITE  
 REGISTERED ENGINEER-SURVEYOR  
 ETOWAH COUNTY, ALABAMA

APPROVED: June 4 - 53  
 W. F. WHITE  
 REGISTERED ENGINEER-SURVEYOR  
 ETOWAH COUNTY, ALABAMA

STATE OF ALABAMA  
 COUNTY OF ETOWAH  
 I, THE UNDERSIGNED, W. F. WHITE, ENGINEER-SURVEYOR, DO HEREBY  
 CERTIFY THAT THE FOREGOING IS A TRUE AND CORRECT  
 COPY OF THE ORIGINAL RECORD OF THE SAID SURVEY  
 AS THE SAME APPEARS IN MY OFFICE RECORDS.  
 W. F. WHITE  
 REGISTERED ENGINEER-SURVEYOR  
 ETOWAH COUNTY, ALABAMA

STATE OF ALABAMA  
 COUNTY OF ETOWAH  
 I, JAMES D. SWIFT, A NOTARY PUBLIC IN AND FOR THE STATE OF ALABAMA,  
 DO HEREBY CERTIFY THAT THE FOREGOING IS A TRUE AND CORRECT  
 COPY OF THE ORIGINAL RECORD OF THE SAID SURVEY  
 AS THE SAME APPEARS IN MY OFFICE RECORDS.  
 JAMES D. SWIFT  
 NOTARY PUBLIC  
 STATE OF ALABAMA

JUN 19 1953  
 RECORDED JUN 23 1953



F-163

*[Handwritten initials]*

90-90