

SKETCH  
 Showing the Division of the Lands of  
**J.H. TEMPLETON**  
 in Sections 32 & 33, Twp. 11 S. R. 7 E. Etowah County, Alabama.  
 G.R. Thomas, C.E., Gadsden, Ala. March, 1932.  
 Scale 1" = 300ft.

State of Alabama,  
 County of Etowah.  
 I, G. R. Thomas, Civil Engineer, hereby certify that this plat is true and correct according to a survey made by me, and that the stakes, distances, bearings and monuments shown hereon are correct and true to the ground.  
 G. R. Thomas, C.E.  
 Civil Engineer.

Approved and adopted on this 12 day of March, 1932.

Delia Templeton	owner.	Nola Templeton	owner.
Irma Odell	owner.	John Odell	husband
Thelma Odell	owner.	Bill Odell	husband
Yule Odell	owner.	Therman Odell	husband

STATE OF ALABAMA  
 COUNTY OF ETOWAH

I, C.O. Freeman, Notary Public, in and for said County and State, hereby certify that Delia (Mrs. J.H.) Templeton, Nola, Irma, Thelma, Mildred and Mae Templeton, wife and daughters of J.H. Templeton, and owners of the property shown on this plat, and whose names are signed hereon, are known to me, hereby acknowledge to me, on this day that being witnessed of the contents of this map, do hereby execute the same voluntarily, on this 12th day of March, 1932.  
 C. O. Freeman, Notary Public, Ex. Off. F.P.

This is done for record in 1534 day of March A. D. 1932.  
 E. L. Hurst  
 Judge of Probate

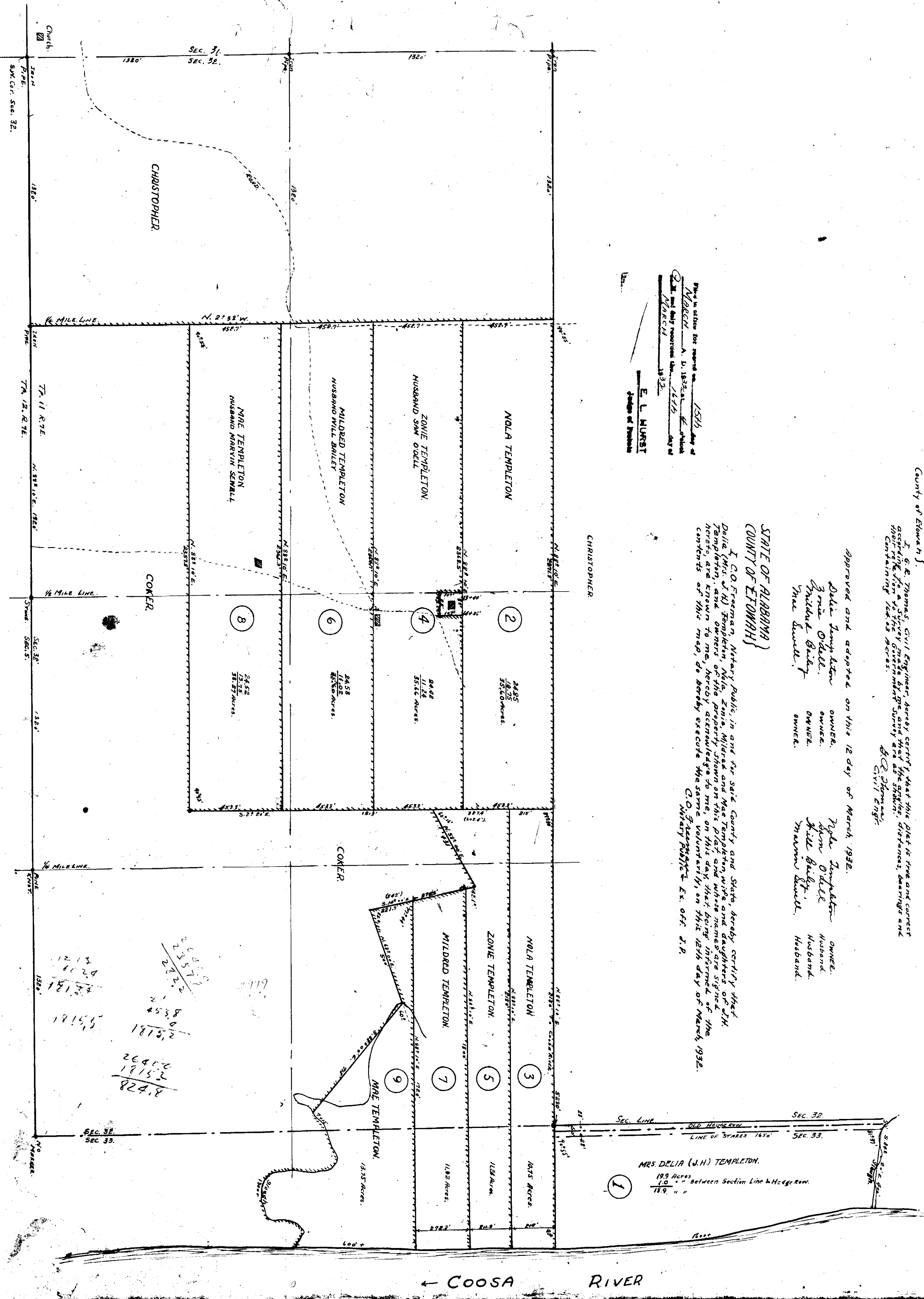

Handwritten calculations:  

$$\begin{array}{r} 2357.7 \\ 2 \\ \hline 1178.85 \end{array}$$

$$\begin{array}{r} 2687.0 \\ 1915.2 \\ \hline 824.8 \end{array}$$