

PAYNE ADDITION

ALTOONA, ALABAMA

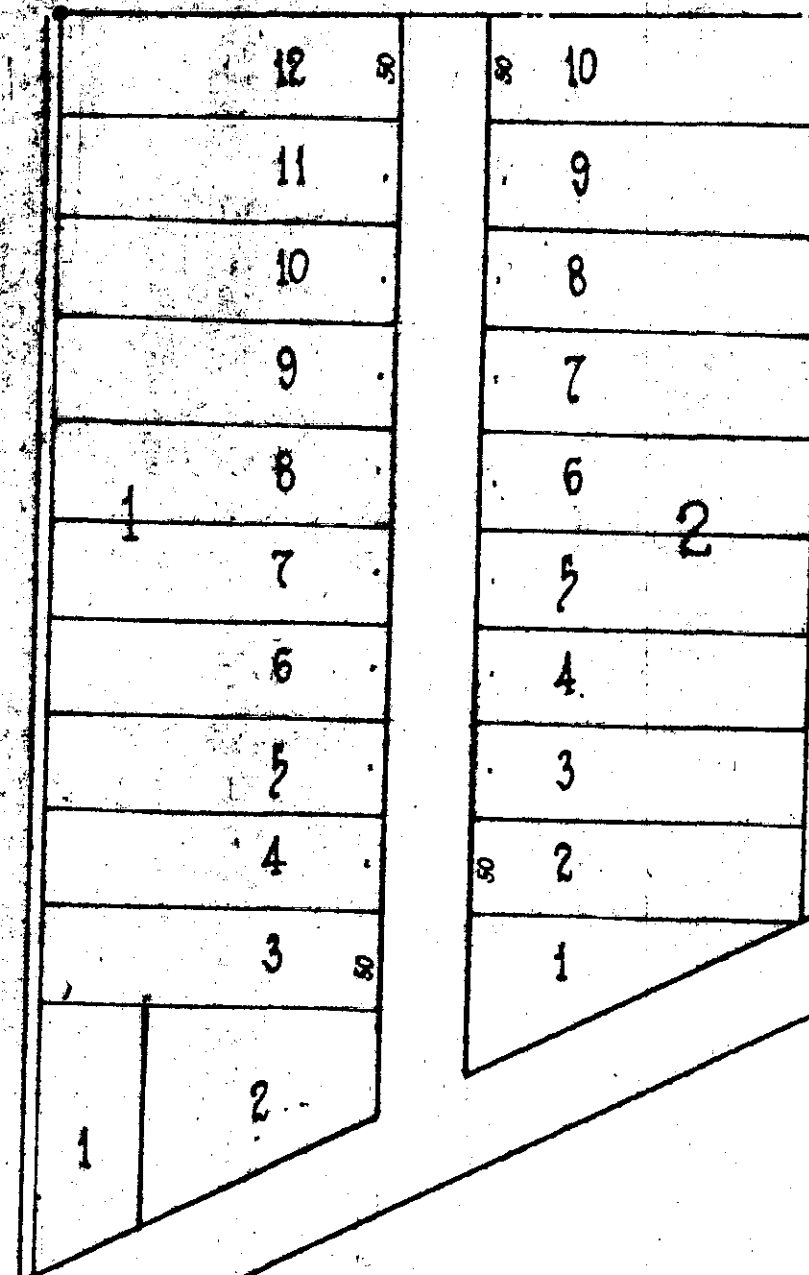

NE Corner SE 1/4
of Section 34

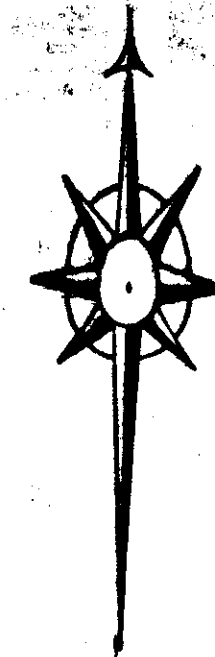

Section Line between Secs. 34 & 35 T₁₁ R₃ E
N 2° 25' W

ALL REGULAR LOTS ARE 50' x 170'
STREETS ARE 50' WIDE
ALLEYS ARE 5' WIDE

I, F. G. Lee, County Surveyor hereby certify that this is a correct plat of the property herein described as surveyed and platted by me this the 28th day of January, 1904.

F. G. Lee, C. E.

I, Z. Payne, hereby ratify adopt, and accept this plat and further certify that I am the owner of all property platted herein. Given under my hand this the 6th day of February, 1904.

Z. Payne

Filed in office for record on the 6th day of February 1904 at 10 o'clock A.M. and duly recorded the 18 day of March, 1904.

J. H. Lovejoy
Judge of Probate

I, J. H. Lovejoy, Judge of Probate for Etowah County, hereby certify that Z. Payne, whose name is signed to this plat did so voluntarily on the day the same bears date after being informed of the contents of same. This Feb. 6, 1904.

J. H. Lovejoy
Judge of Probate