

HUGHES ADDITION NO. 3

ATTALLA, ALABAMA
NW 1/4 - SEC. 2 TP 12 R 5 E

For Recommendation see Plat Book B Page 157

From Attalla
From Attalla
Tennessee & Georgia Railroad
Anniston & Cincinnati Railroad
To Gadsden
To Anniston

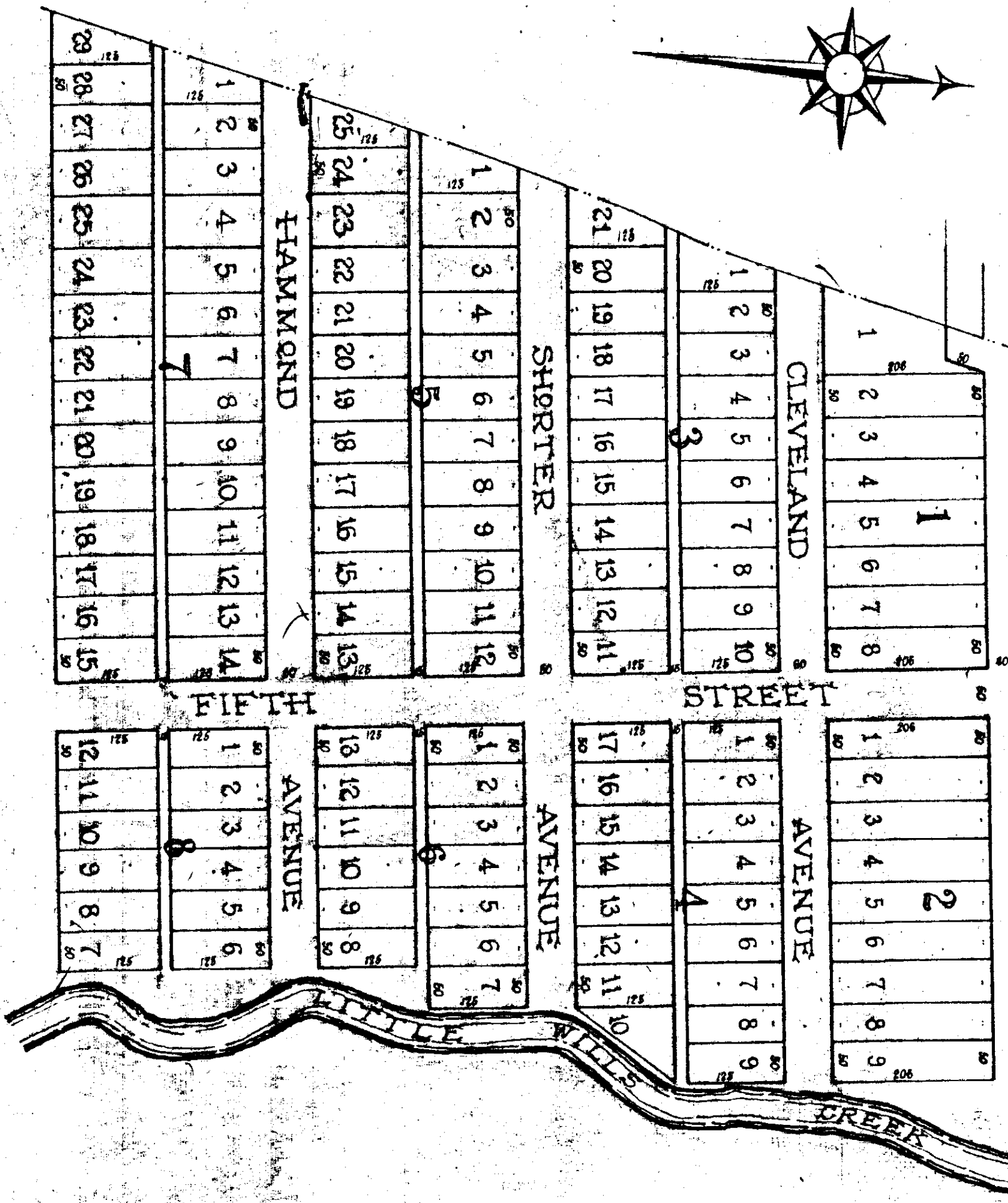
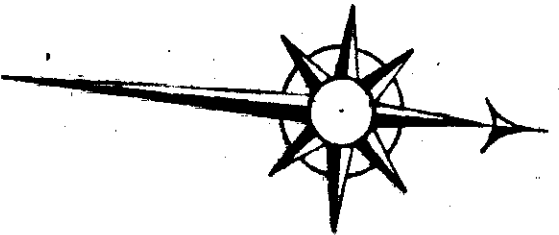

January 28, 1890
I hereby certify that this is a correct plat of Hughes Addition no. 3 to the City of Attalla,
as surveyed and shown by J. H. Morgan and myself.
John F. Jack

The State of Alabama, Etowah County
J. A. Tallman, Judge of Probate in and for said County and State hereby certify that J. R.
Hughes, D. A. Hughes, C. E. Cox, M. A. Hughes and F. A. Tripps, whose names are signed to the fore-
going declaration and who are known to me, acknowledged before me on the date that being in
formed of the contents of the declaration, they executed the same voluntarily on the day the same
bears date. Given under my hand this January 28, 1890.
J. A. Tallman, Judge of Probate

State of Alabama, Etowah County
We, the undersigned owners of the property herein described and pleased by Jack Morgan,
Civil Engineers and Surveyors, hereby testify and adopt the same as correct,
Given under our hands this January 28, 1890.

J. R. Hughes
D. A. Hughes
C. E. Cox
M. A. Hughes
F. A. Tripps

Filed in office January 28, 1890. J. A. Tallman, Judge of Probate