

TO HOKES BLUFF CEMETERY
ASSOCIATION
IN NE 1/4 - NE 1/4, S15, T11S, R7E

BLUFF HILLS ADDITION

N 55° 56' E
1/4" = 555.7'
1/4" = 140.0'
1/4" = 35.0'



DRIVEWAY (Chart)

Old Cemetery Area

9.50' To Section Line
To a point on section line that is 1036.9' South of Sec. Corn NE Corner of Sec. 15

H-2

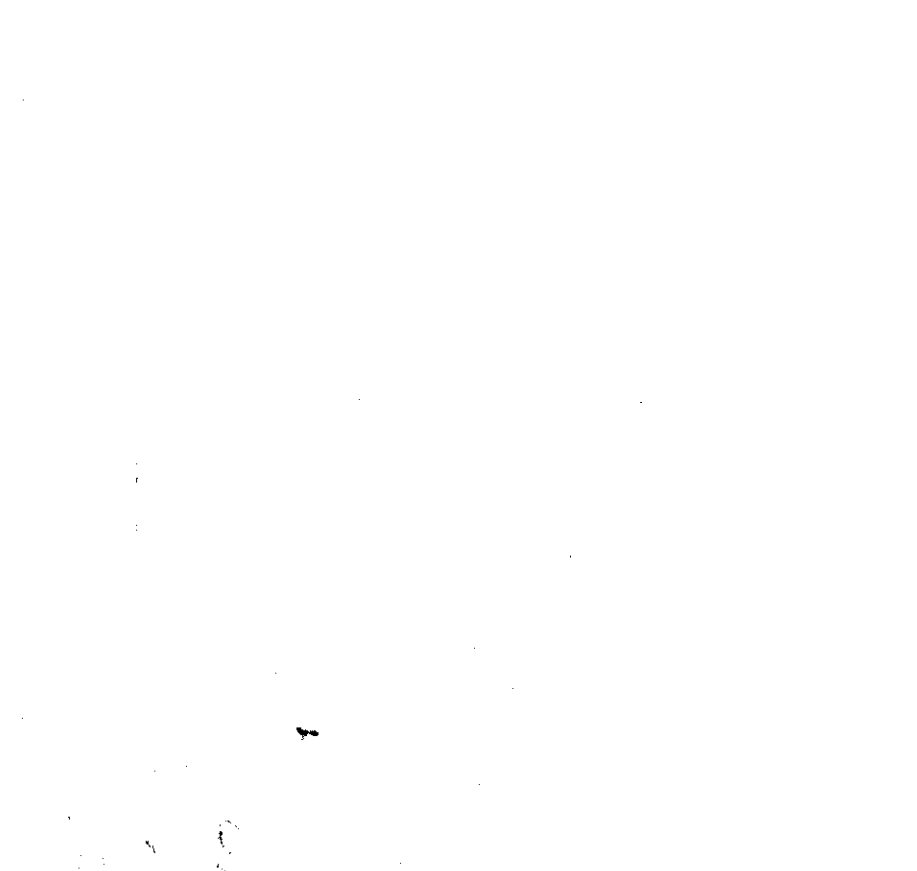
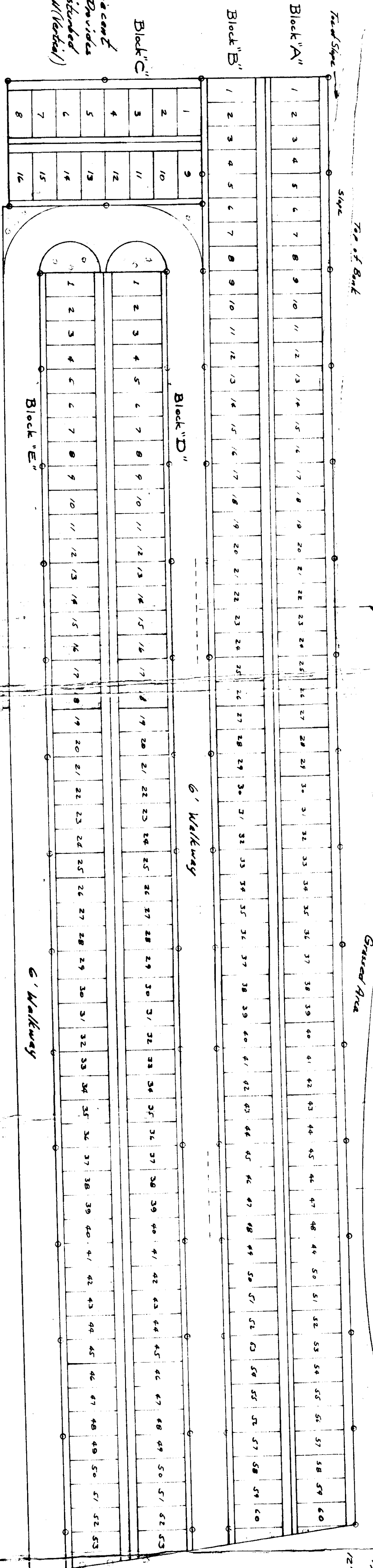
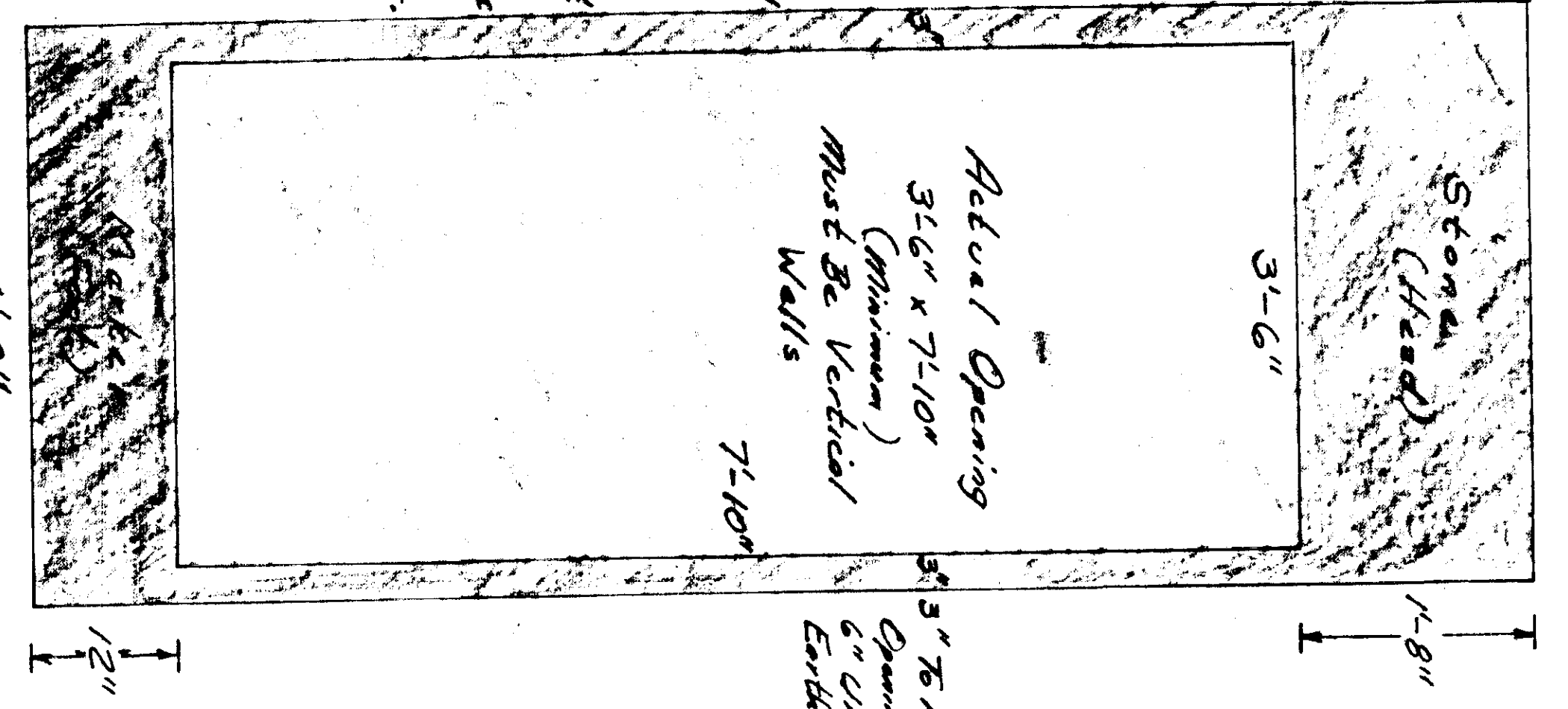

- = Family or Headstone
- = Foodmarker
- = Shrubs, flowers, plants
- = Benches, rest area
- = concrete corner

GENERAL NOTES:

1. All lots on this addition are 4'-0" x 10'-6" so that they can serve for any size grouping with headstones on either tier.
 2. Unusable areas to be planned for shrubs. Walkways to be contoured and should be provided with some rest areas.
 3. Scale 1" = 10' 242 lots in this addition.
- Example of Grouping arrangement to accommodate any size family.

DATE: 10/15/67
DRAWN BY: [Signature]
CHECKED BY: [Signature]
SCALE: 1" = 10'

Approved: [Signature]
W.B. [Signature]
34 May 1967

DRIVE

