

REARRANGEMENT OF LOT 1, KEELING ADDITION  
AS PLATTED IN PLAT BOOK "A" PAGE 265

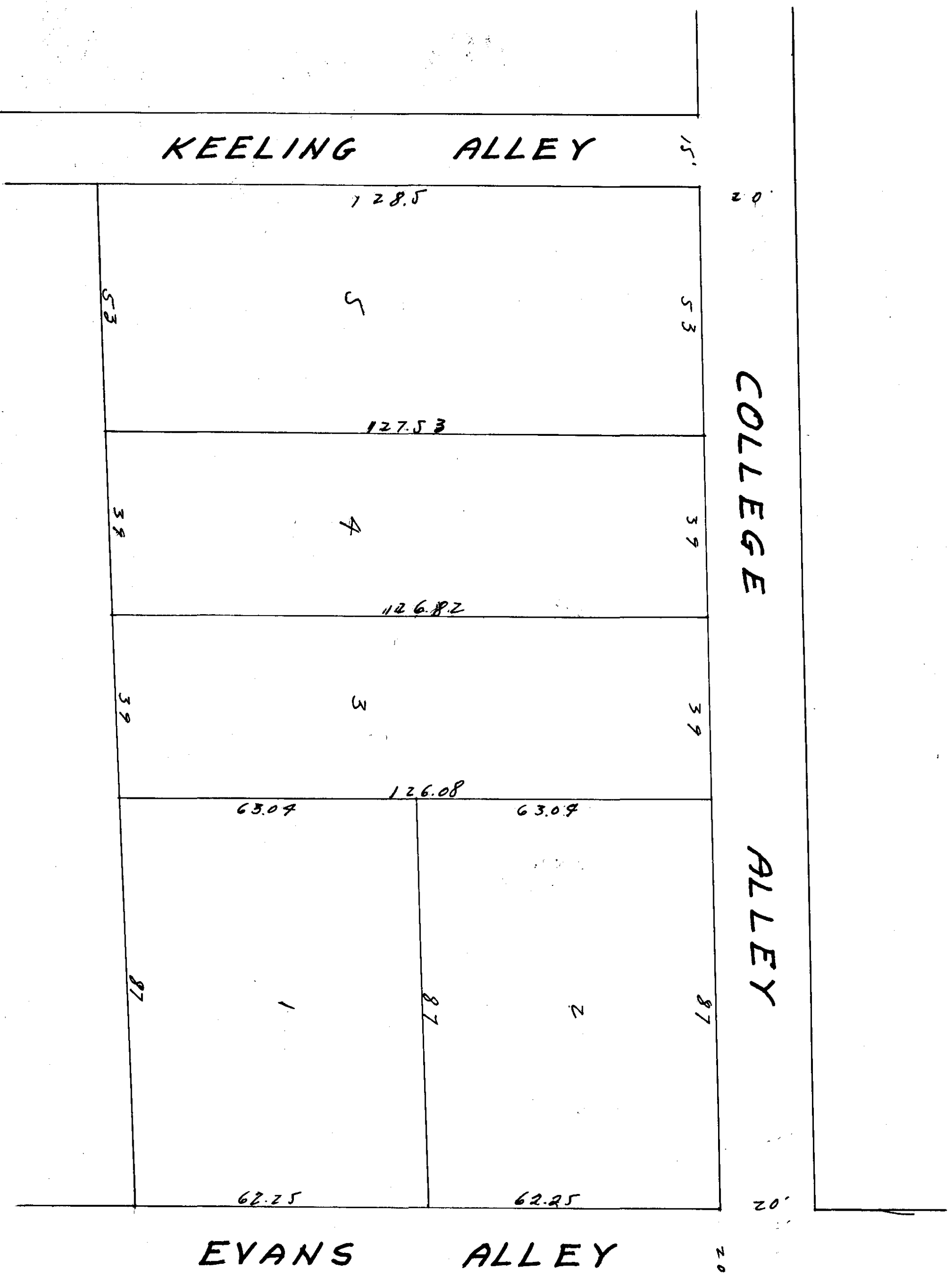

STATE OF ALABAMA:  
COUNTY OF ETOWAH:  
I, T. E. Wolford, a Registered Engineer-Surveyor of Georgia, do hereby certify that I have made of actual survey of the lands shown on the same same is true and correct as shown on the map. According to my survey this 15th day of July, 1948.  
Signed: T. E. Wolford, C.E. & L.S.  
T. E. Wolford  
Aid. License No. 29.

STATE OF ALABAMA:  
COUNTY OF ETOWAH:  
I, B. B. Phillips, Assistant Public and for and county and state, do hereby certify that on this day appeared before me the above named owners of lands herein described and being known to me to be known before me that executed same voluntarily on the given day in some legal date. 1948 day of July, 1948.  
Signed: B. B. Phillips, N.P.

STATE OF ALABAMA:  
COUNTY OF ETOWAH:  
We the undersigned owners of the lands herein described do hereby ratify, confirm and adopt this plat as being true and correct. Given under our hands this 15th day of July, 1948.  
Signed: Thos. T. Williams, owner.  
Signed: O. B. Williams, owner.

Approved: by City of Goodson Planning Board  
F. M. Feltz  
Approved: T. E. Wolford,  
City Engineer.

Filed for record on the 20th day of July, A. D. 1948, at 10:50 o'clock A. M. and duly recorded this 23rd day of July, 1948.  
Judge of Probate  
Frank A. Hagan

