

MAP OF  
 IRON YARD NO. 4  
 BASIC IRON  
 SOU. IRON & STEEL CO.  
 ALA. CITY DIVISION

JULY 13, 1910 SCALE: 1" = 100'

Iron Yard No. 1:  
 Commencing at SW Cor. of Sec. 6 T 12 R 6 East;  
 thence N 89° E 865'; thence N 16° 30' E 300.2';  
 thence N 18° 15' W 659.4'; thence N 46° 30' E to Sta.  
 18 + 453 SW Corner Iron Yard; thence S 16° 15' E 58.7';  
 thence S 31° 15' E 396.9'; thence N 57° 45' ? 40.8';  
 thence N 56° 15' W 451'; thence S 32° W 36.8' to Sta.  
 18 + 453.  
 Inclosing 44 Acres, more or less.

N 89° 30' E

Filed in this office for record Sept. 2nd,  
 1910. Recorded this 2nd day Sept. 1910.  
 J. W. Penn  
 Judge of Probate

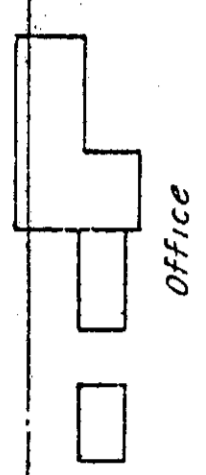
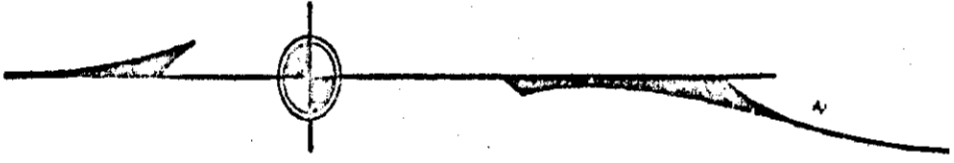

Office

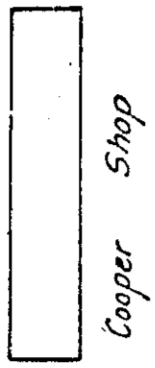

Cooper Shop



Oil House



Lab.



Machine Shop



B.S.

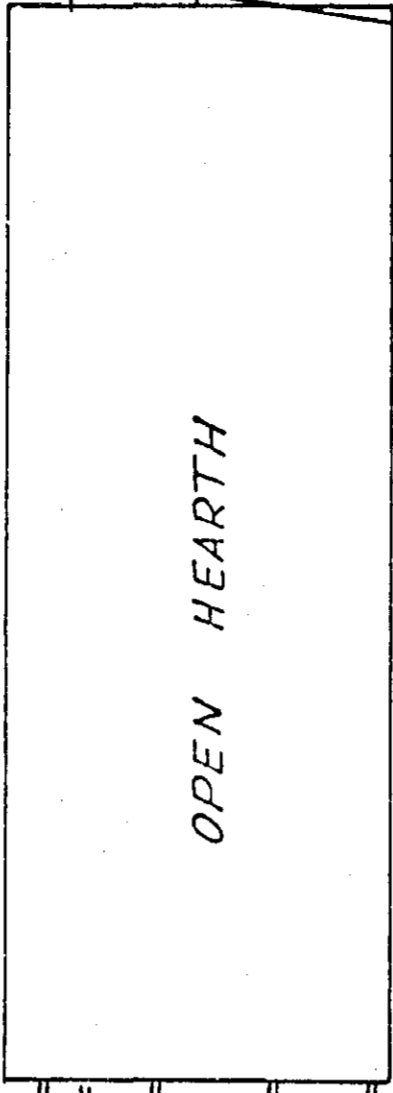

OPEN HEARTH

Hot Metal Track

Foundry

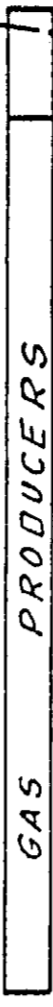

GAS PRODUCERS

#2 Coal Trestle

N 87° 57' W 365.5'

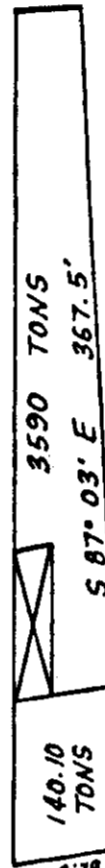

140.10 TONS

5590 TONS

S 87° 03' E 367.5'

Total, 5000 Tons Basic Iron 7/13/10

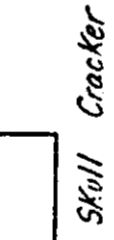

Skill Cracker

Fence

N 89° 00' E 495'

N 89° 30' E 1325.5'

N 77° 57' W 37.8'

IRON YARD NO. 4

Filed in this office for record on  
 July 25, 1910 and recorded Sept. 3, 1910  
 J. W. Penn  
 Judge of Probate