

MAP OF  
THE DORMAN ADDITION  
TO ALTOONA, ALA.

SCALE: 1"=100'

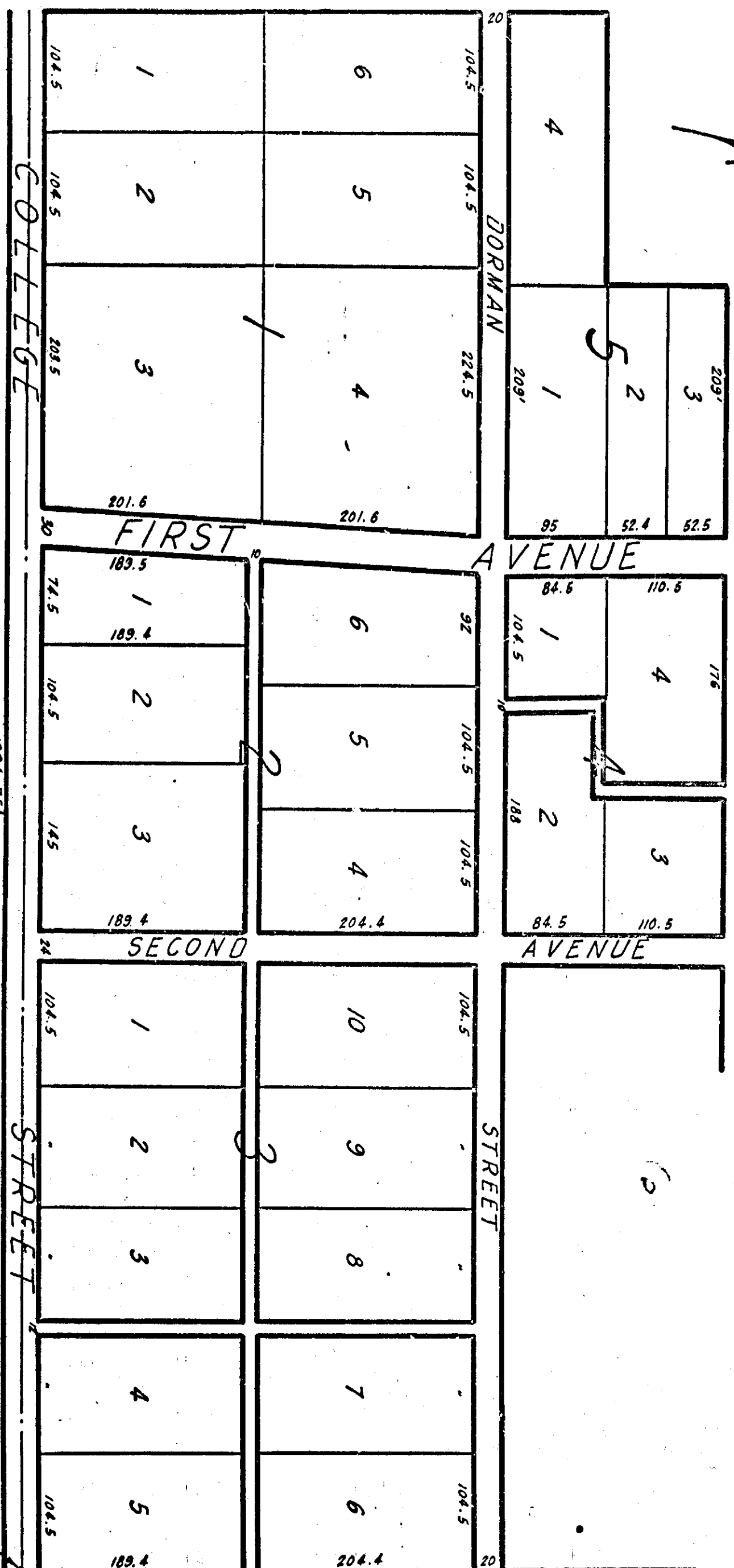
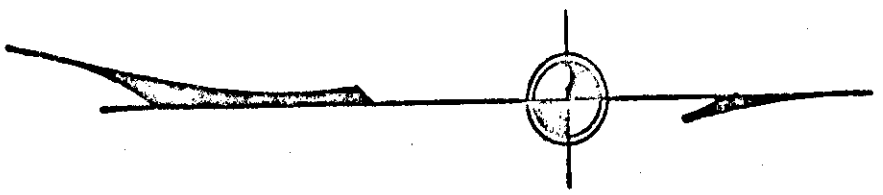

As surveyed and platted by me this the 26th day of March, 1907, lying and being in the SW 1/4 of the SE 1/4 Section 33, Township 11, S R 3 E. *J. B. Kile*  
County Surveyor, Etowah Co.

State of Alabama  
Etowah County  
I, T. W. Hood, a Justice of the Peace of said County and State, hereby certify that J. C. Ward, A. D. Thompson, W. O. Hullett, W. C. Thompson, W. J. Cleveland, J. F. Thompson, V. B. Dunn, T. R. Bynum, J. C. Dorman, E. J. Thrasher, L. E. Jones, owners whose names are signed to the annexed plat or map and who are known to me, acknowledged before me on this day that being informed of the contents of the annexed plat or map with Streets, Avenues, Alleys, Lots and Blocks as therein laid off, marked and numbered they voluntarily adopted the same.  
Given under my hand and seal this the 5th day of May, 1908.

*T. W. Hood*  
Justice of the Peace

We the undersigned owners of the property herein described as platted by F. G. Lee on the 26th day of March, 1907, hereby adopt same and grant to the public usage, the Streets, Avenues and Alleys as shown herein given under my hand this the \_\_\_ day of \_\_\_ 1907.

- J. G. Wood*
- A. D. Thompson*
- W. O. Hullett*
- W. C. Thompson*
- W. J. Cleveland*
- J. F. Thompson*
- V. B. Dunn*
- T. R. Bynum*
- A. C. Dorman*
- E. J. Thrasher*
- L. E. Jones*

Filed in office for record this 8 day of May 1908 A.D. at 10 o'clock of May, 1908  
*J. W. Payne*  
Judge of Probate

SE Corner SW 1/4 SE 1/4  
Sec 33 T 11 S R 6 E.