

MAP OF
MOUNTAIN TERRACE
IN N 1/2 OF SW 1/4 33 11 6

SCALE: 1" = 200'

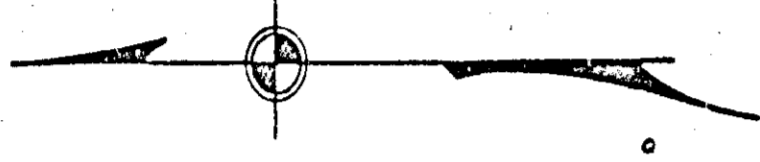

The State of Alabama
Etowah County
I, J. W. Williams, a Notary Public in
and for said County in said State, hereby
certify that T. A. Stringer, whose name
as vice-president of the F. M. Brannon Realty
Company, a corporation organized in the State
of Alabama, is known to me as the person
and who is known to me as the person
before me on this day that being inform-
ed of the contents of the map or plat
one certificate thereon, he as such
officer and with full authority executed
the same voluntarily for and as the act of
said owner under my hand this - day
of August, 1914.

Attest:
Secretary

J. W. Williams,
Notary Public

The State of Alabama
Etowah County
I, T. A. Stringer, Vice-President
of the F. M. Brannon Realty Company, a corporation
organized in the State of Alabama, do
hereby certify that this is a true and correct
map or plat, showing the streets, alleys &
public grounds, and giving the length, width
and name of each, and the number and dimen-
sions of the lots, and showing the relation of
the land platted to the government survey
of the NW 1/4 of the SW 1/4 of Sec. 33, Tp. 11 S.,
R. 6 E., Etowah County, Alabama. I, as
vice-president of the F. M. Brannon Realty
Company, do hereby certify that the said map
or plat, and the rights, privileges and fran-
chises therein, were lawfully acquired by
me or my predecessors in interest, and that
the same are now in my possession, and that
I am not aware of any other persons claiming
an interest in the same.

F. M. Brannon Realty Company, by:
T. A. Stringer - Vice-President
A. G. Bunchkamp -
Civil Engineer

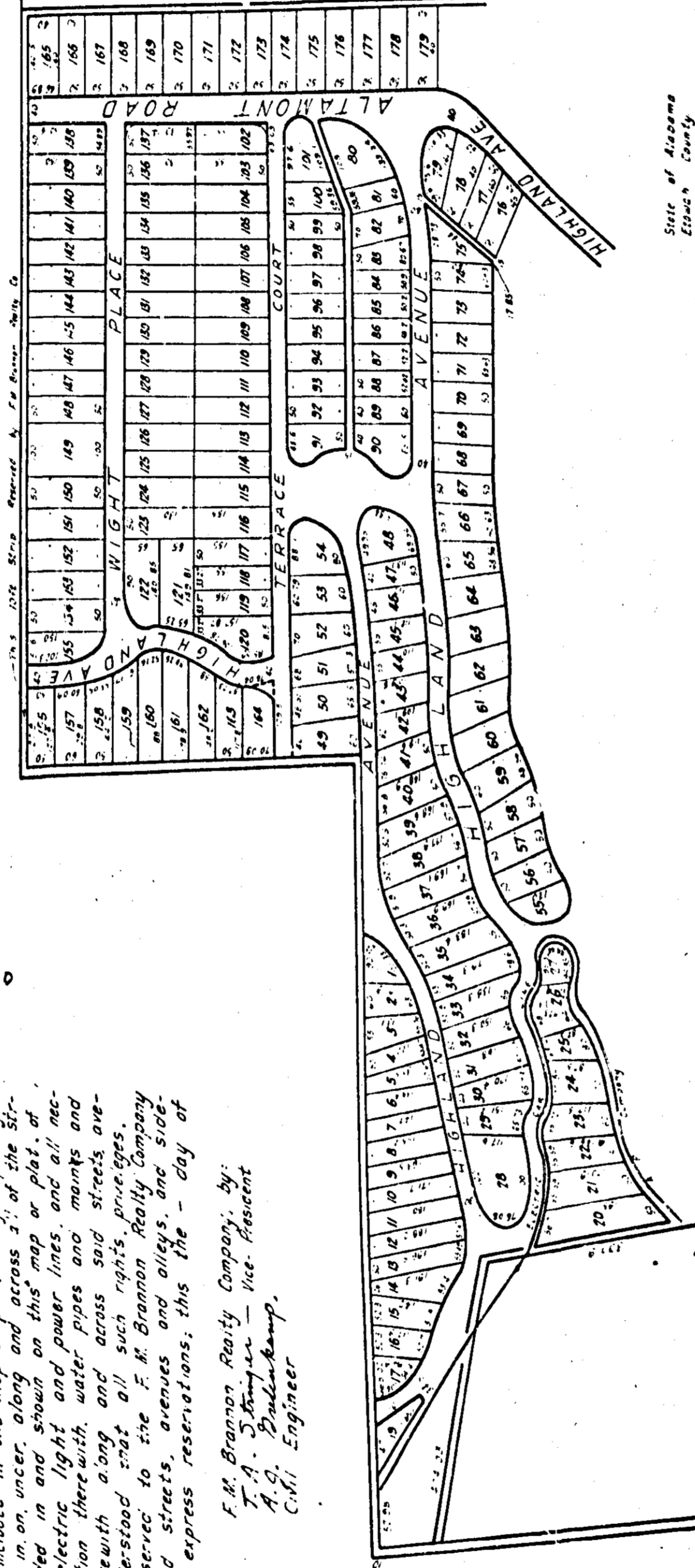

The State of Alabama
Etowah County
I, T. A. Stringer, Vice-President
of the F. M. Brannon Realty Company, a corporation
organized in the State of Alabama, do
hereby certify that this is a true and correct
map or plat, showing the streets, alleys &
public grounds, and giving the length, width
and name of each, and the number and dimen-
sions of the lots, and showing the relation of
the land platted to the government survey
of the NW 1/4 of the SW 1/4 of Sec. 33, Tp. 11 S.,
R. 6 E., Etowah County, Alabama. I, as
vice-president of the F. M. Brannon Realty
Company, do hereby certify that the said map
or plat, and the rights, privileges and fran-
chises therein, were lawfully acquired by
me or my predecessors in interest, and that
the same are now in my possession, and that
I am not aware of any other persons claiming
an interest in the same.

This entire map of Mountain Terrace
is recorded in the Public Records
of Etowah County, Alabama, on page 153
of the records of said county.

F. M. Brannon Realty Company,
by:
T. A. Stringer - Vice-President
A. G. Bunchkamp -
Civil Engineer