

1. F. G. Lee, a Civil Engineer and Court's Surveyor, who made this map and surveyed the property contained hereon, hereby certifies that the map is correct, that it correctly shows the subdivisions into which the property is divided.

It also shows the angles of the boundaries of the property, alleys, as well as the width of the streets, avenues, and blocks; it also shows the relation of the land so platted to the Original Government Survey, and the unresigned Fair Haven Realty Co. hereby ratifies and adopts the said map and survey as correct, dedicating to the public use all streets, avenues, and alleys this the 9th day of May, 1913.

F. G. Lee
County Surveyor & C.E.
Fair Haven Realty Co., by:
Geo. J. Brudel, Pres.

The State of Alabama
Etowah County

I, H. S. Patterson, a Notary Public in and for said County, hereby certify that Geo. J. Gruber, whose name is signed as president of the Fair Haven Realty Company, to the within map, and who is known to me, acknowledged before me on this day that being informed of the contents he executed the same voluntarily, for and as the act of said Fair Haven Realty Co. Given under my hand and seal this the 9th day of May, 1913.

H. S. Patterson
Notary Public

The State of Alabama
Etowah County

I, H. S. Patterson, a Notary Public in and for said County hereby certify that F. G. Lee, whose name as County Surveyor is signed to the within map, acknowledged before me on this day that he executed the same, and that the map is correct. Given under my hand and seal, this the 9th day of May, 1913.

H. S. Patterson
Notary Public

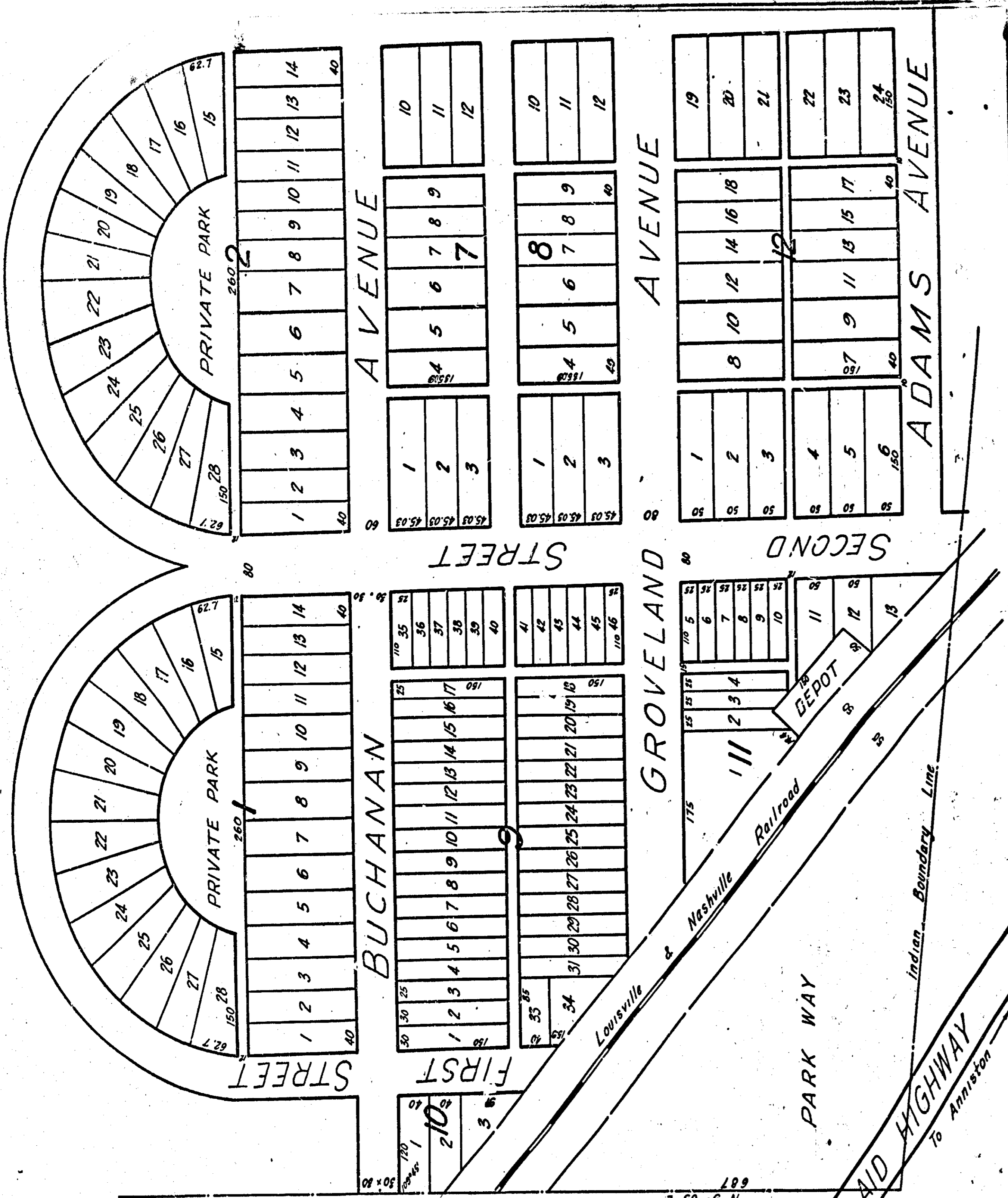

STATE AID HIGHWAY
To Anniston
To Gadsden