

SOUTH HIGHLANDS ADDITION
TO GADSDEN & ALABAMA CITY, ALA
PROPERTY OF
GADSDEN, ALABAMA CITY, LAND CO

SCALE: 1"=100'

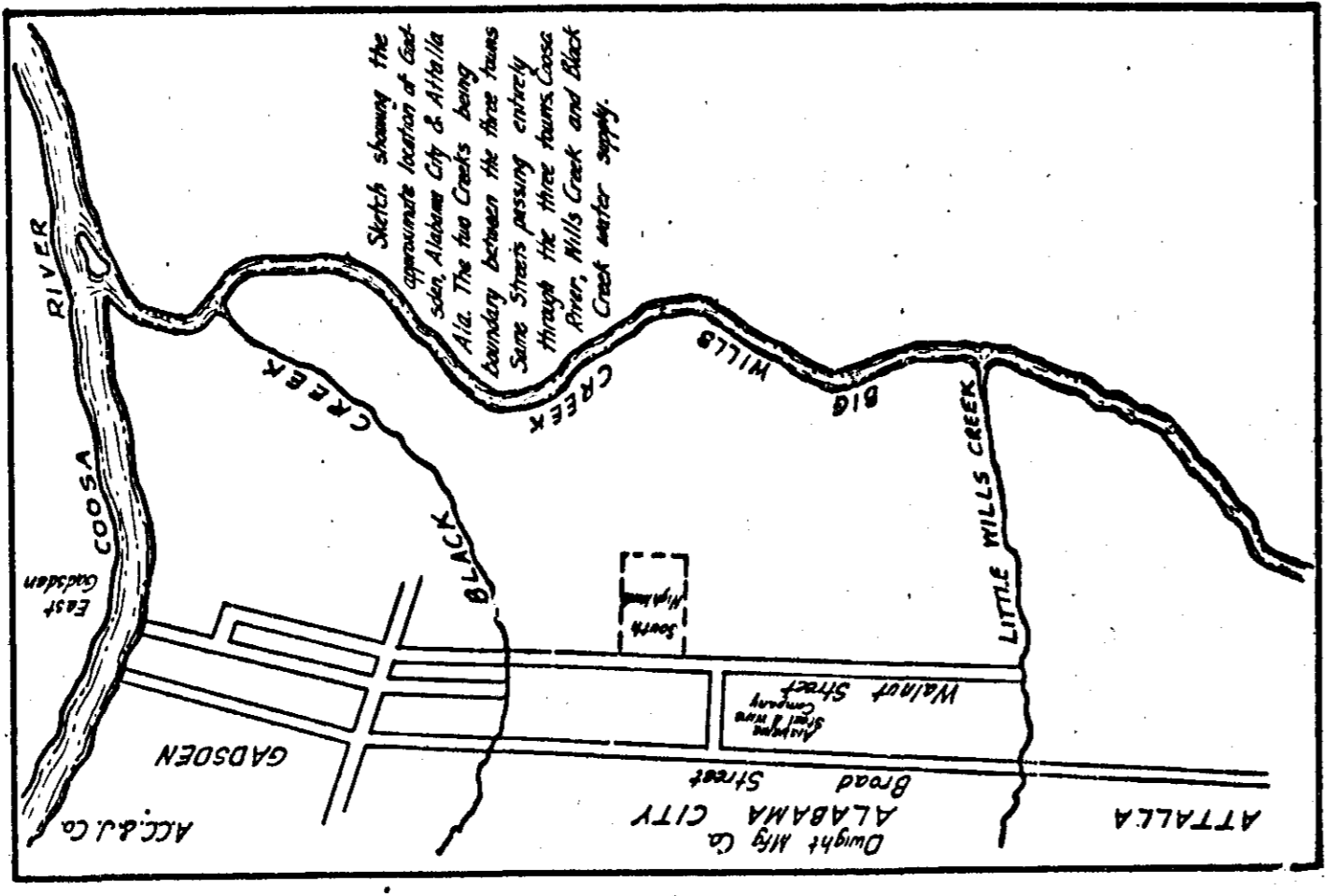
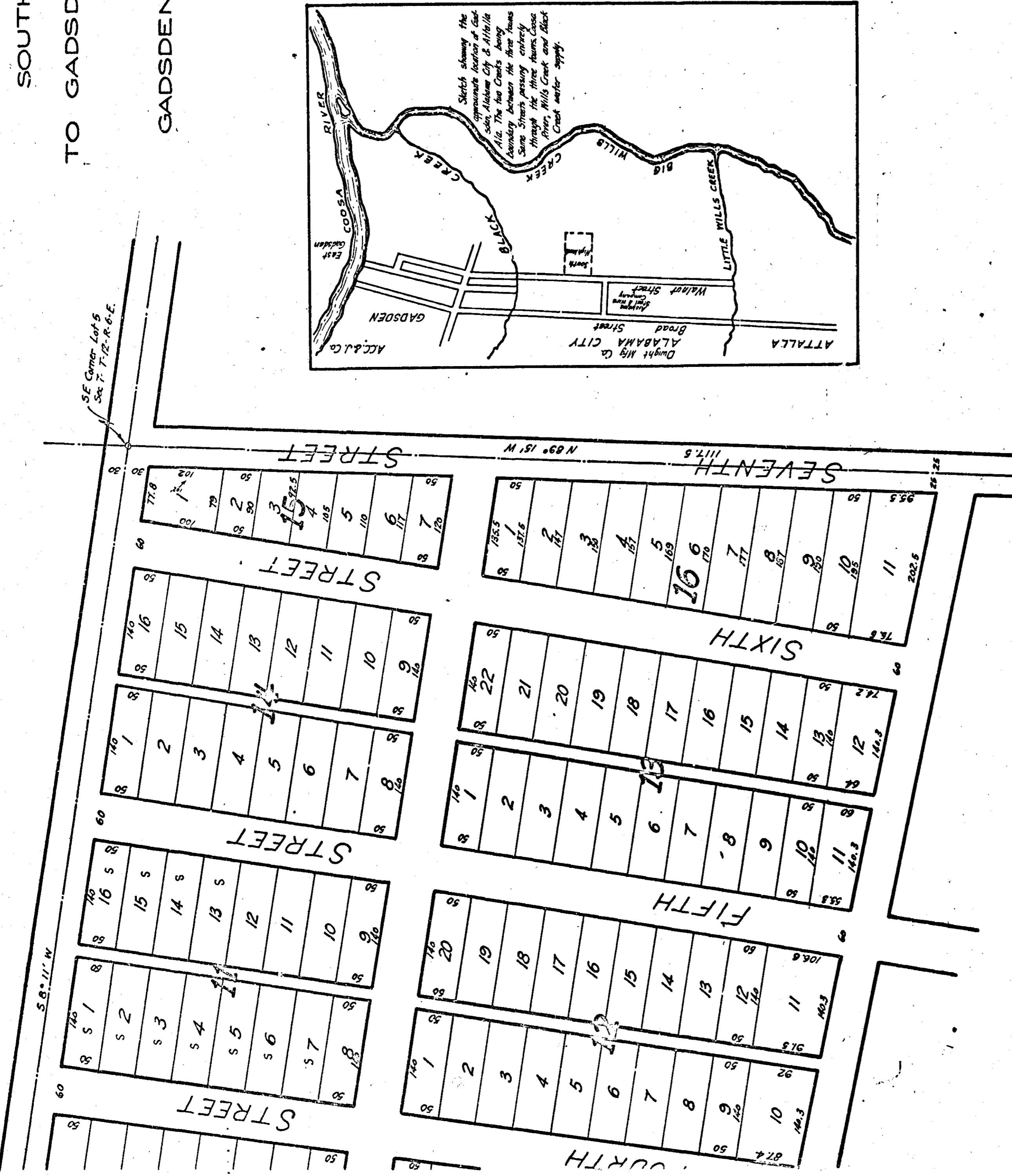

State of Alabama
Etowah County

I, J. M. Ross, Judge of Probate in and for said County and State hereby certify that C. R. Goldman as president of the Gadsden, Ala. City Land Co, a corporation whose name as such president is signed to the foregoing conveyance of T. M. Lister, C. E. & Surveyor of the map or plat of the herewith described property of or of the said Gadsden, Ala. City Land Co, a corporation and who is known to me acknowledged before me on this day, that being informed of the contents of said certificate and of said map or plat the said corporation and through him as its president and he as such president for and on behalf of said corporation executed said certificate and said map or plat voluntarily on the day the same bears date.

Given under my hand this 4th day of December, 1906.

J. M. Ross,
Judge of Probate

C. R. Goldman,
President

Gadsden, Ala. City Land Co. (a corporation)
By, and as witness of said Company: