

GOODYEAR HEIGHTS

IN GOVERNMENT FRACTION 'C', SEC. 7 T₁₂ R₇
GADSDEN, ALA.

THIS MAP WAS
RECORDED ON PP
466 AND 467 IN
THE OLD PLAT
BOOK 'A'.

State of Alabama
Etowah County

I, R. P. Sitz, who made this map and surveyed the property contained therein, hereby certify that the map is correct, that the map correctly shows the subdivisions into which the property is divided. It also shows each lot and block and their numbers as well as the dimensions of same. It also shows each Street and Avenue, their names, widths and bearings, it also shows the relation of the property so subdivided to the Original Government Survey and the undersigned the G. W. Smith Co., Inc. owners of the property so subdivided, hereby ratifies and adopts the same as being correct.

Given under my hand this the 18th day of March, 1929.

R. P. Sitz, Engineer
The G. W. Smith Co. Inc.
by G. W. Smith, Owner,
President

The State of Alabama
County of Etowah

I, Clyde Camp a Notary Public in and for said State and County, hereby certify that R. P. Sitz, Civil Engineer, whose name is signed to the within map or plat, and the G. W. Smith Co. Inc (G. W. Smith, pres.) as owners of the lands embraced in said map, whose names are signed to the foregoing conveyance, and who are known to me, acknowledged before me on this day, that being informed of the contents of the conveyance they executed the same voluntarily for and as an act of their own free will and accord.

Given under my hand this the 18th day of March, 1929.
(N. P. Seal) Clyde Camp,
Notary Public

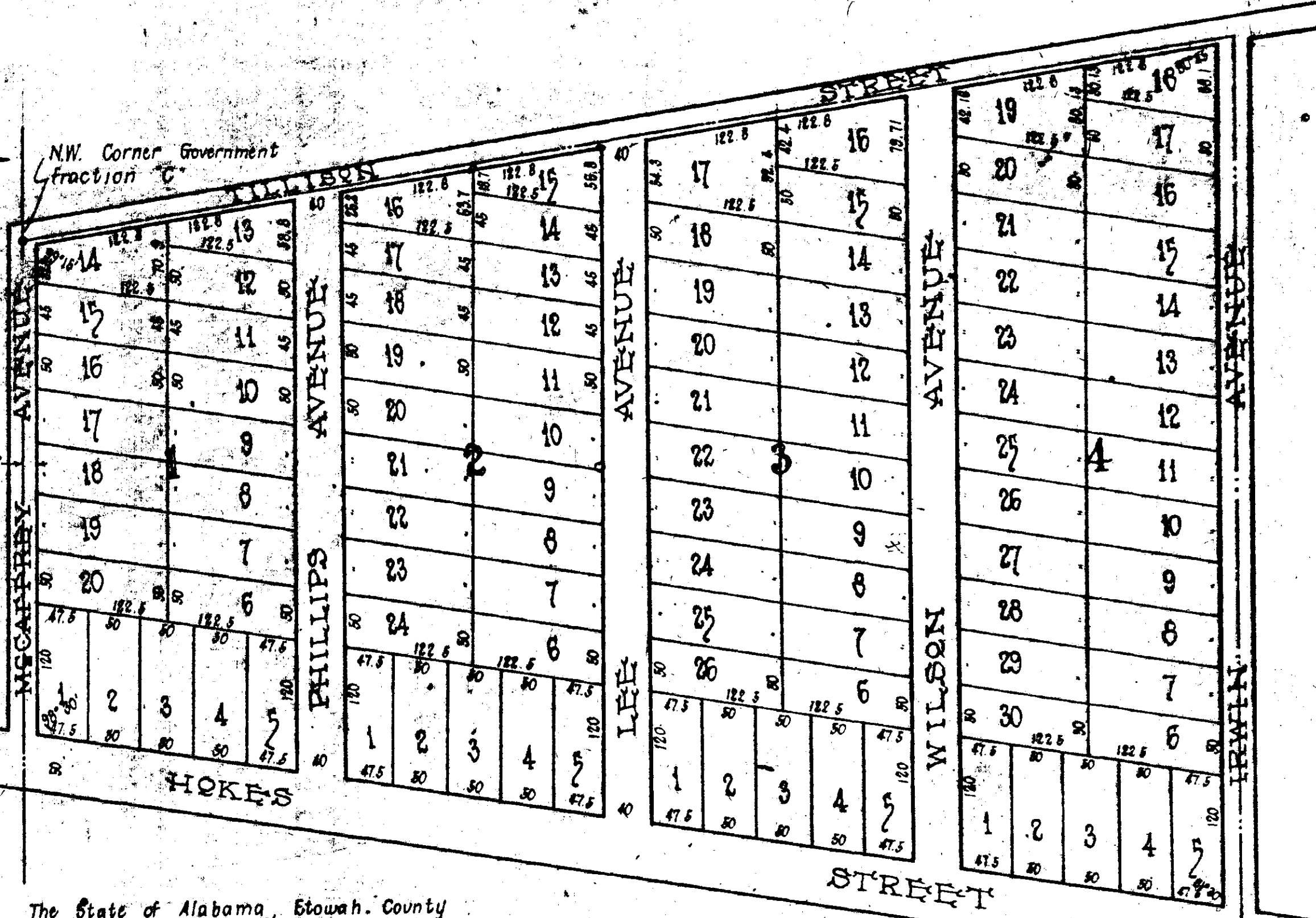
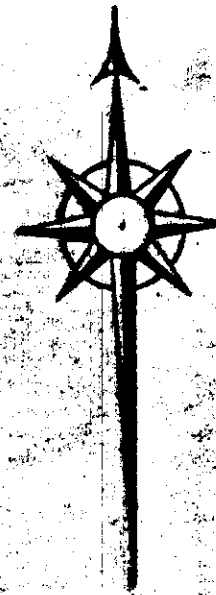

The State of Alabama, Etowah County
I hereby certify that the within instrument was filed in this office for record 18, March, 1929 at 8 o'clock A. M. and recorded in plat record "A" pages 466-67 and examined.

E. L. Hurst, Judge of Probate

466