

CARLISLE CITY

IN SECTION 29 Tp 10 R 5 E
 MINERAL AND MINING RIGHTS REBERVED
 ALL LOTS NOT OTHERWISE SPECIFIED ARE 100'x140'
 SEE PAGE 237

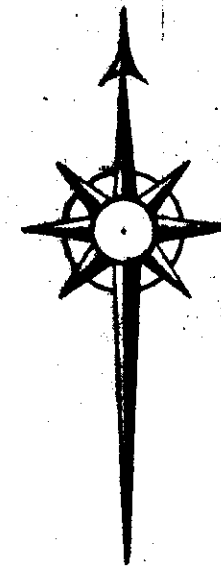

*Survey and plat of streets
 Survey 39 Page 324*

VACATION MISC. 133 Page 29

The State of Alabama, Etowah County
 I, D. G. Henderson, as agent for Carlisle Estate,
 hereby ratify and adopt the above plat of Survey
 made by C. N. Alford, C.E. 3/8/01
 D. G. Henderson, Agent

Filed in office for record on the 9th day of
 March A.D., 1901 at 9 o'clock A.M. and duly recorded
 the 11th day of March A.D., 1901.

J. H. Lovejoy
 Judge of Probate

Map and Survey by C. N. Alford, C.E., Feb. 18, 1901

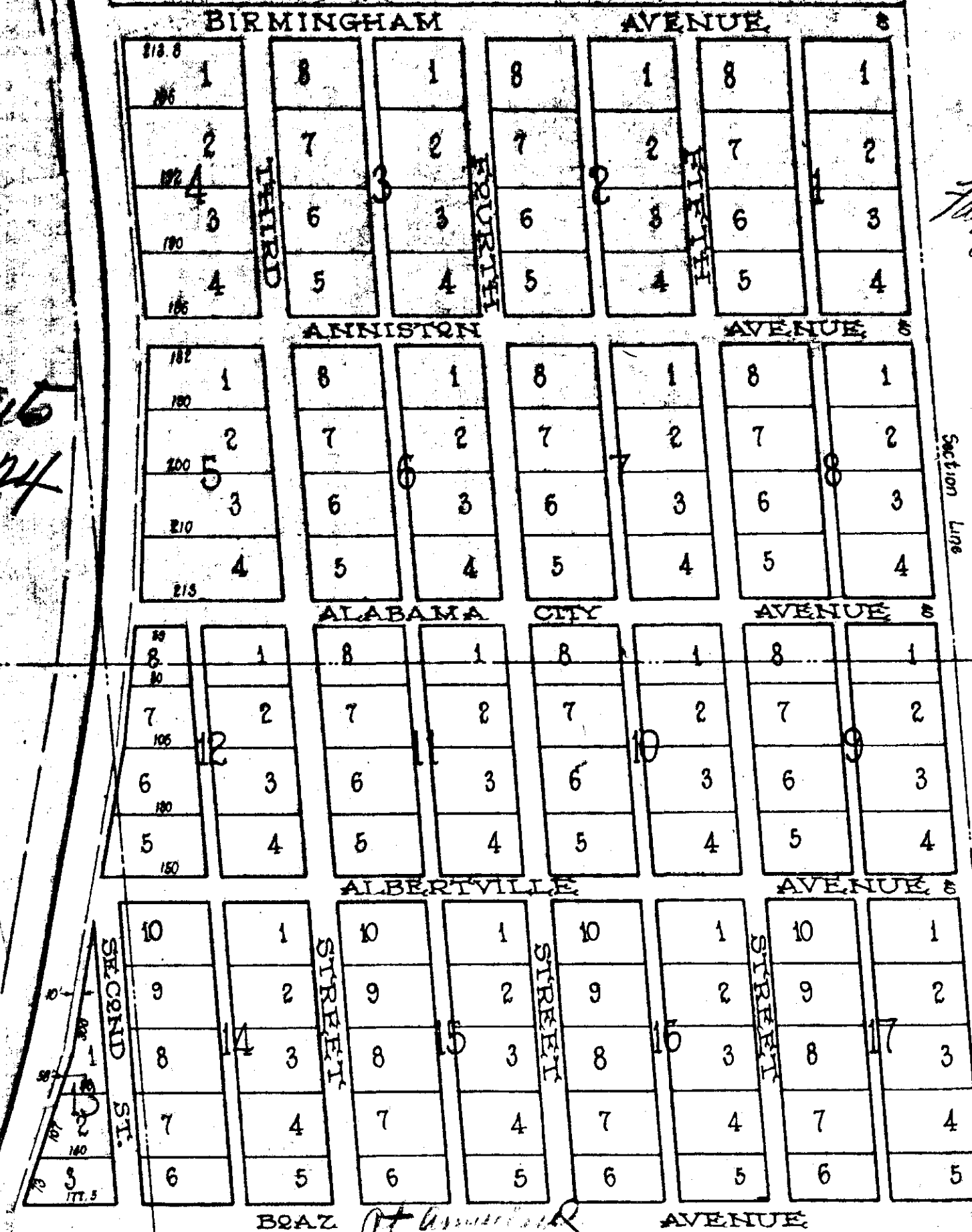

Continued on page 237

For Carlisle Misc. Map 170 p 143