

CHRISTOPHER AND STEWART
 ATTALLA, ALA.
 ADDITIONAL SURVEY by SINGLETON

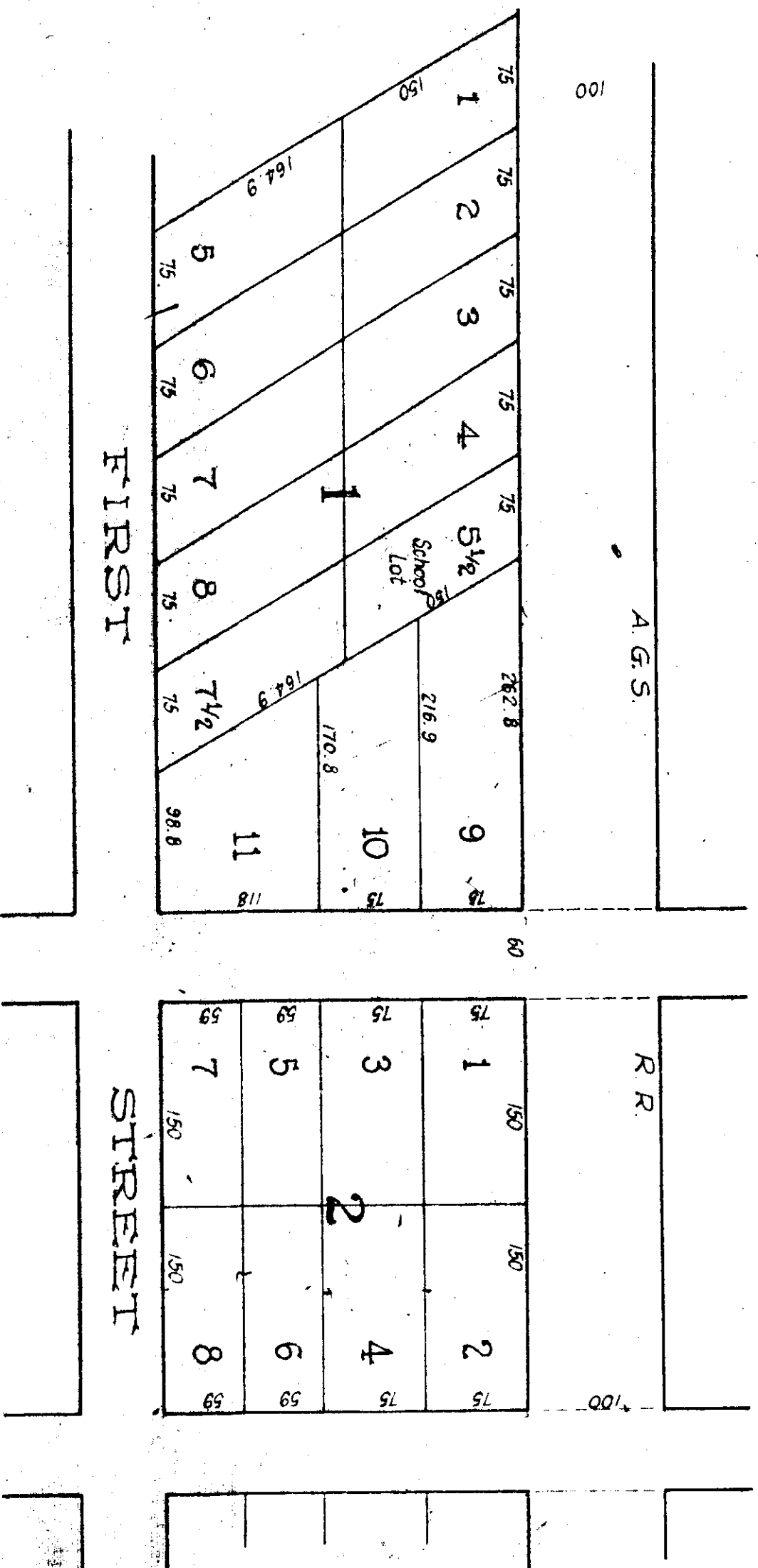
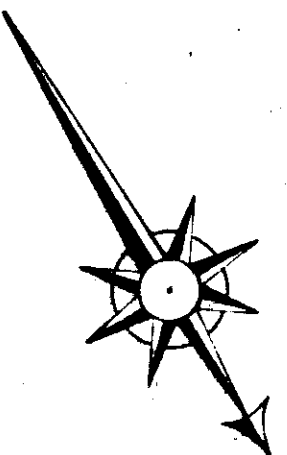

State of Alabama, Etowah County
 I, J. S. Stewart, owner of the land herein described as platted and subdivided by J. J. Singleton, Surveyor, hereby ratify and adopt same as correct given under my hand this the 6th day of July, 1888.
 J. S. Stewart

State of Alabama, Etowah County
 I, J. A. Tallman, Judge of Probate for said county hereby certify that J. S. Stewart, whose name is signed to the foregoing declaration and who is known to me, acknowledged before me on this day that being informed of the contents of the same, he executed the same voluntarily on the day the same bears date.
 Given under my hand this the 6th day of July, 1888.
 J. A. Tallman
 Judge of Probate

I certify that this is a correct map of this property as surveyed and subdivided by me.
 J. J. Singleton, Jr
 Civil Engineer

Filed in office July 6, 1888. Recorded July 6, 1888.
 J. A. Tallman
 Judge of Probate

Note:
 This Map was recorded on pages 70 & 71
 in the Old Plat Book 'A.'